

**ALASKA VICINITY MAP**

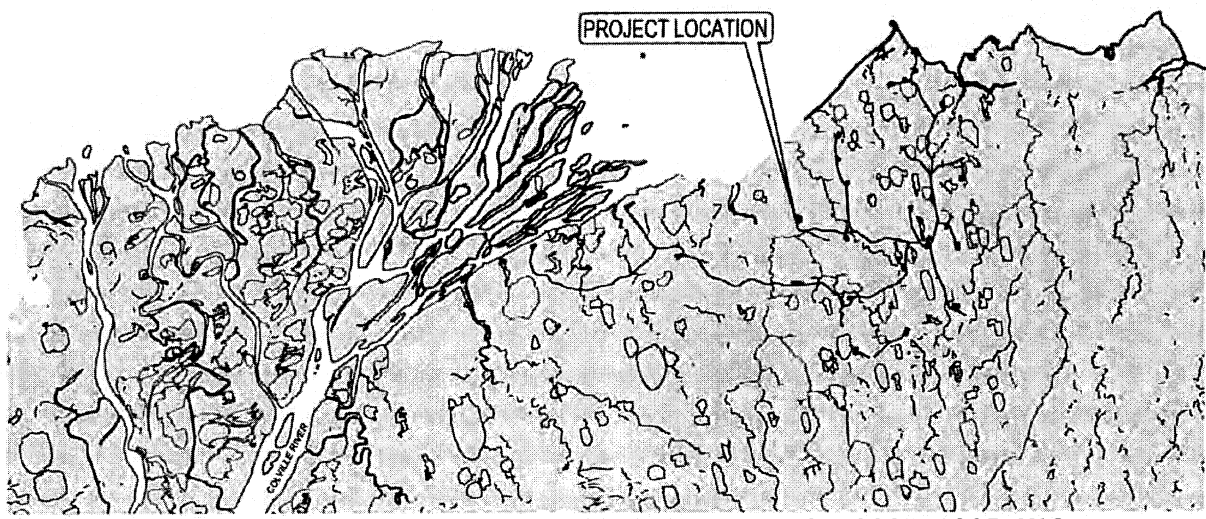

**NUNA VICINITY MAP**

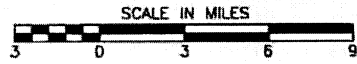

POA-2005-1295-M13  
 Harrison Bay  
 Caelus Energy Alaska  
 Sheet 1 of 7

**PURPOSE:**  
 CONSTRUCT GRAVEL PAD FOR  
 OILFIELD DEVELOPMENT

**DATUM:** BPMSL, NAD27 ASP ZONE 4

**ADJACENT PROPERTY OWNERS:**  
 1. STATE OF ALASKA DNR  
 2. US DEPT OF INTERIOR BLM

**APPLICANT:** CAELUS ENERGY  
 ALASKA, LLC

**LOCATION:** T12N, R8E  
 UMIAT MERIDIAN

**ADDRESS:** 700 G STREET  
 SUITE 600  
 ANCHORAGE, AK 99501

**PROPOSED:** PAD CONSTRUCTION

**IN & NEAR:** KUPARUK RIVER UNIT

**COUNTY:** ANS BOROUGH  
**STATE:** ALASKA

**SHEET** 1 of 7  
 8-29-2014

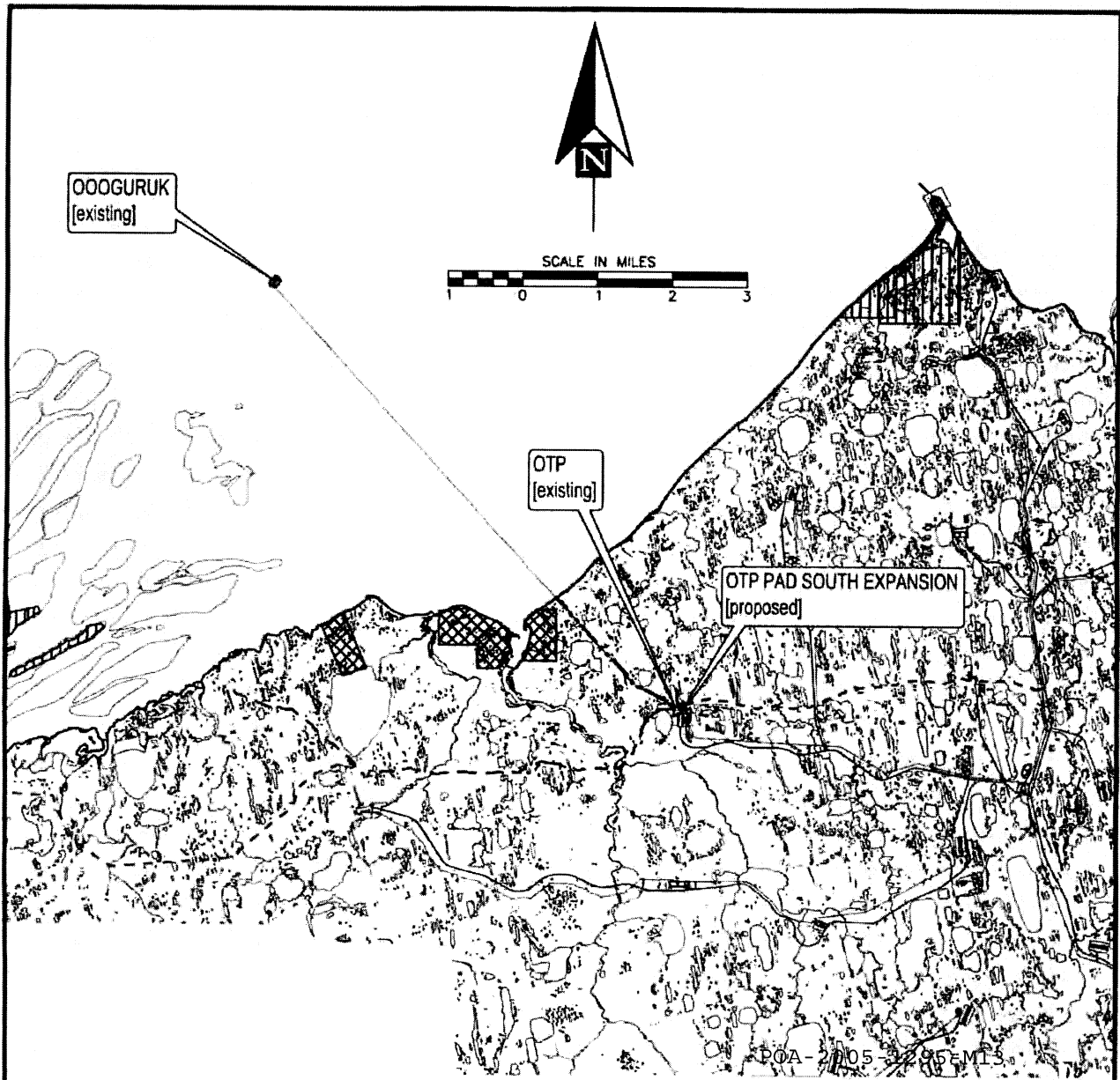

**OTP FACILITIES OVERVIEW**

POA-2005-3285-MIS  
 Harrison Bay  
 Caelus Energy Alaska  
 Sheet 2 of 7

OTP PAD SOUTH EXPANSION	
PAD FOOTPRINT	3.0 ACRES
PAD FILL QUANTITY	40,000 CY

-  NATIVE ALLOTMENT
-  US SURVEY

**REFERENCE:**

APPLICANT: CAELUS ENERGY ALASKA, LLC  
 PROPOSED: PAD CONSTRUCTION

AT: ALASKA

SHEET **2** of **7** 8-29-2014

THIS MAP PROJECTION IS BASED UPON ALASKA STATE PLANE, NAD 27. THIS MAP IS BASED ON DATA PROVIDED BY THE U.S. GEOLOGICAL SURVEY, THE ALASKA DEPARTMENT OF NATURAL RESOURCES, AND PIONEER NATURAL RESOURCES, ALASKA.

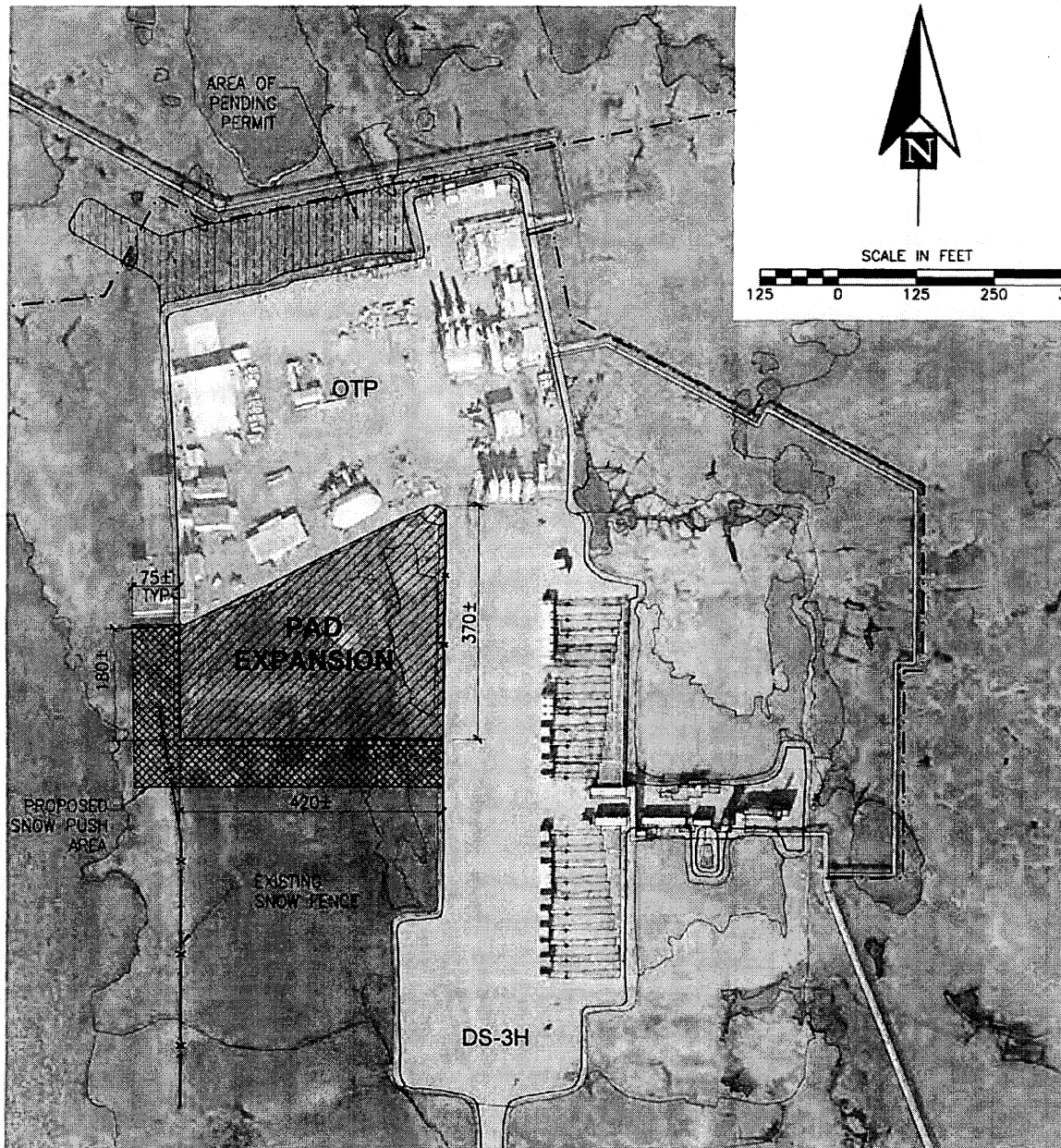

**PAD EXPANSION FOOTPRINT**

POA-2005-1295-M13  
 Harrison Bay  
 Caelus Energy Alaska  
 Sheet 3 of 7

REFERENCE:  
 APPLICANT: CAELUS ENERGY  
 ALASKA, LLC  
 PROPOSED: PAD CONSTRUCTION  
 AT: ALASKA  
 SHEET **3** of **7** 8-29-2014

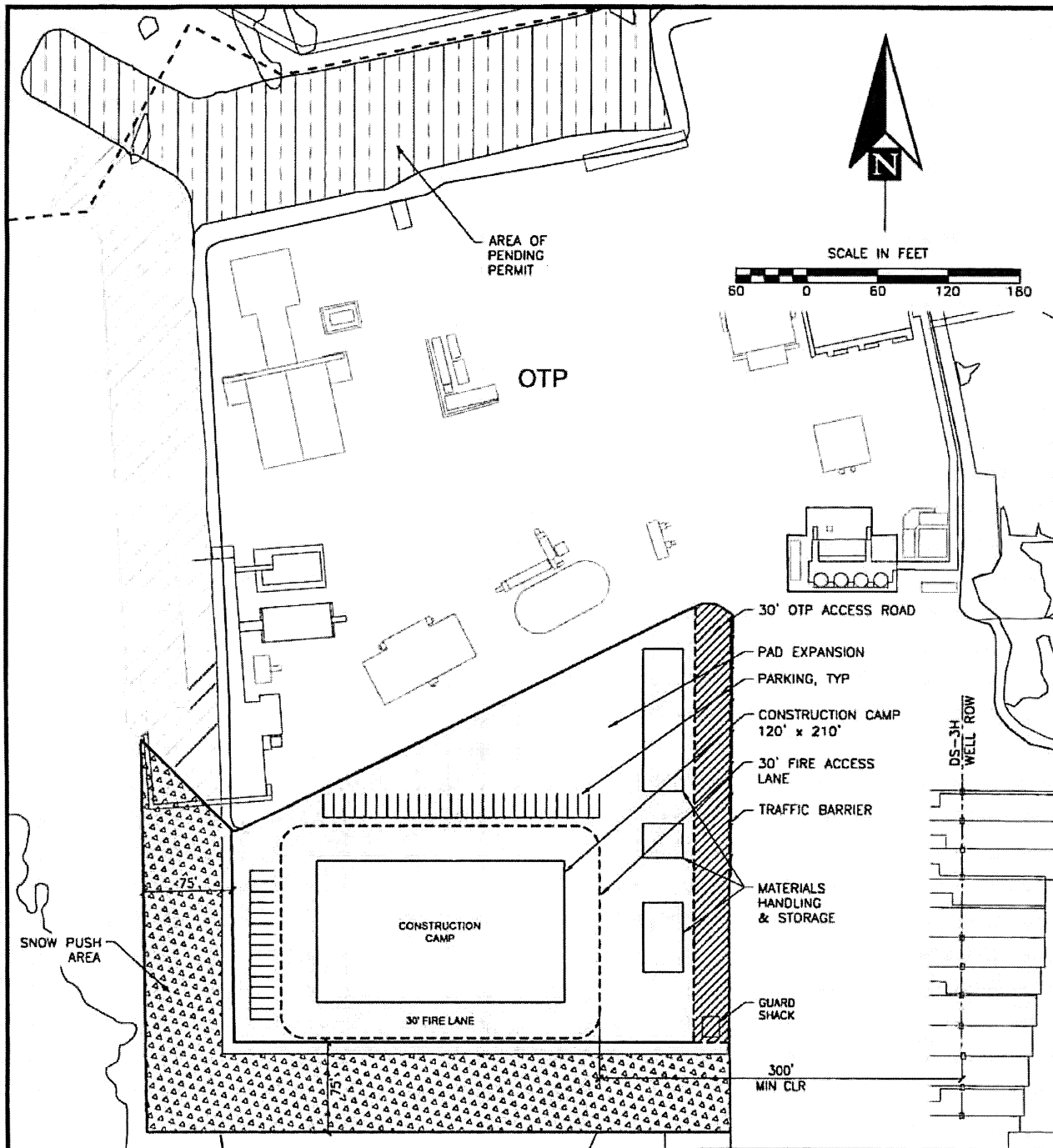

**PAD EXPANSION LAYOUT**

POA-2005-1295-M13  
 Harrison Bay  
 Caelus Energy Alaska  
 Sheet 4 of 7

**REFERENCE:**

APPLICANT: CAELUS ENERGY  
 ALASKA, LLC  
 PROPOSED: PAD CONSTRUCTION  
 AT: ALASKA  
 SHEET **4** of **7** 8-29-2014

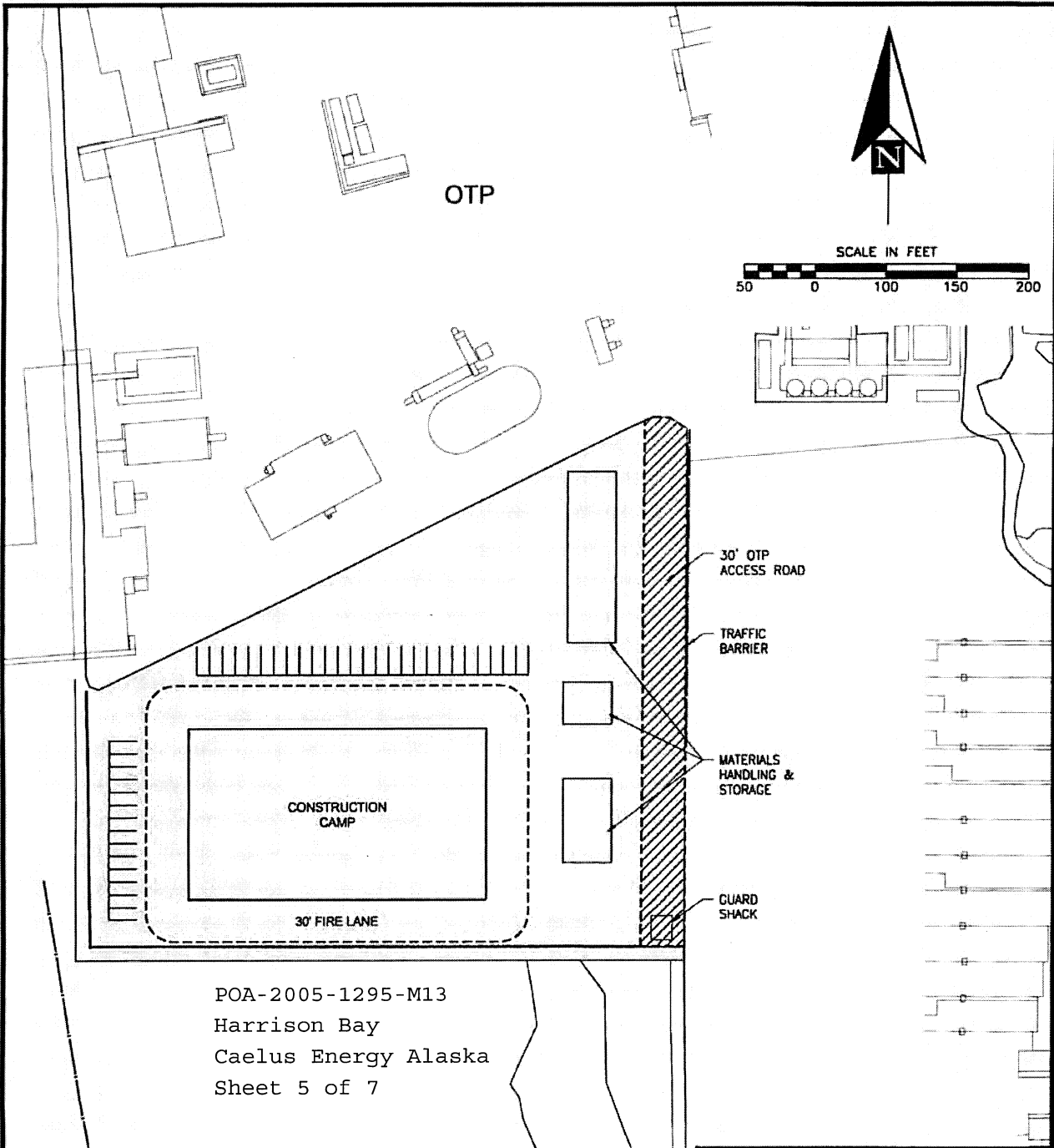

POA-2005-1295-M13  
 Harrison Bay  
 Caelus Energy Alaska  
 Sheet 5 of 7

**CONSTRUCTION PHASE I**

REFERENCE:  
 APPLICANT: CAELUS ENERGY ALASKA, LLC  
 PROPOSED: PAD CONSTRUCTION  
 AT: ALASKA  
 SHEET **5** of **7** 8-29-2014

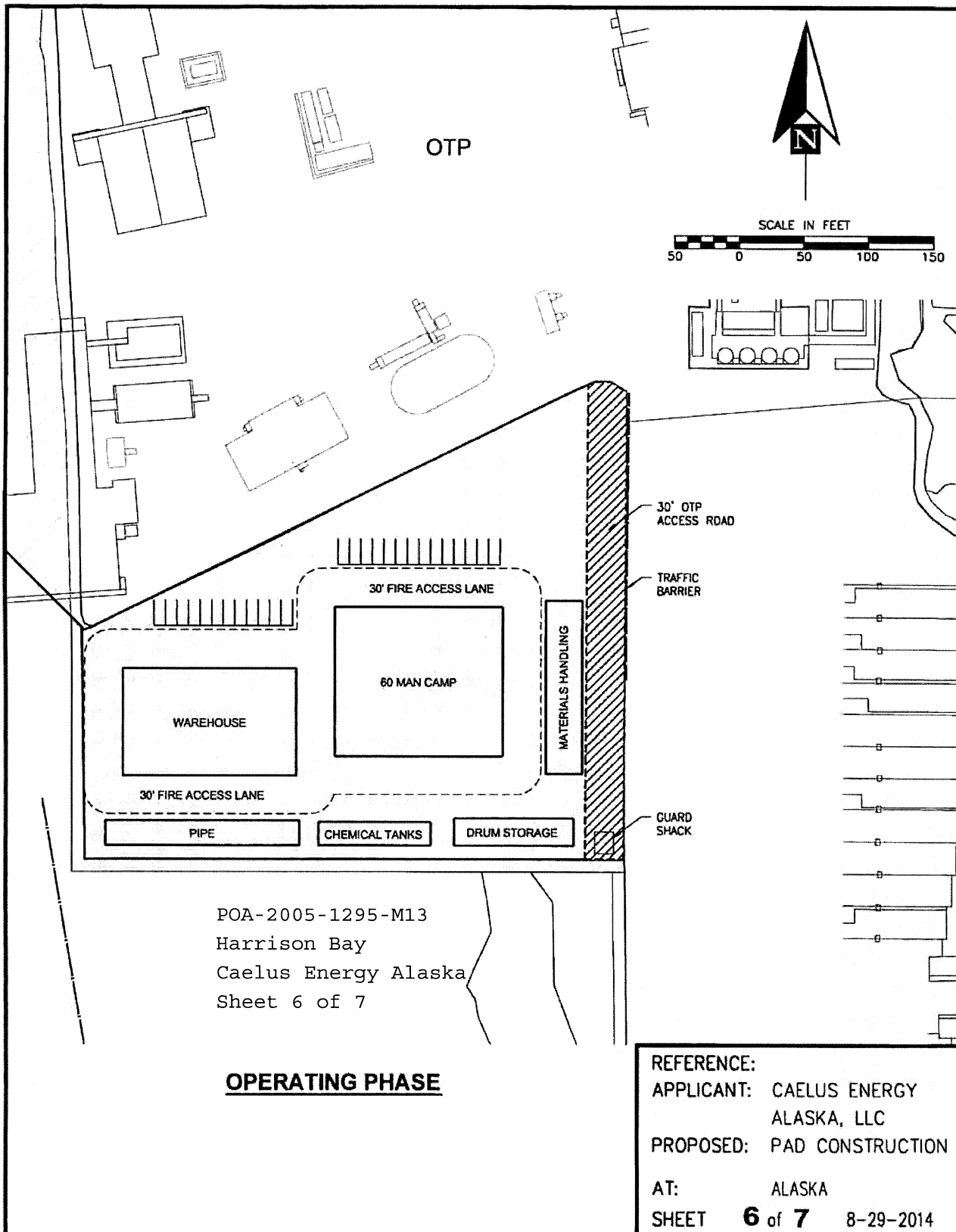

OTP

SCALE IN FEET

50 0 50 100 150

30' ODP  
ACCESS ROAD

TRAFFIC  
BARRIER

30' FIRE ACCESS LANE

60 MAN CAMP

WAREHOUSE

MATERIALS HANDLING

30' FIRE ACCESS LANE

PIPE

CHEMICAL TANKS

DRUM STORAGE

GUARD  
SHACK

POA-2005-1295-M13  
Harrison Bay  
Caelus Energy Alaska  
Sheet 6 of 7

**OPERATING PHASE**

REFERENCE:  
APPLICANT: CAELUS ENERGY  
ALASKA, LLC  
PROPOSED: PAD CONSTRUCTION  
AT: ALASKA  
SHEET **6** of **7** 8-29-2014

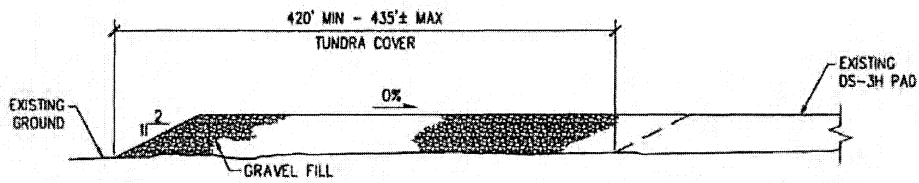

**OTP PAD SOUTH EXPANSION TYPICAL LONGITUDINAL SECTION**  
NOT TO SCALE

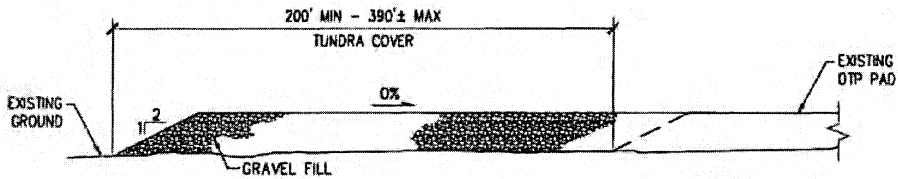

**OTP PAD SOUTH EXPANSION TYPICAL TRANSVERSE SECTION**  
NOT TO SCALE

POA-2005-1295-M13  
Harrison Bay  
Caelus Energy Alaska  
Sheet 7 of 7

NOTE:  
MAX TOE TO TOE DIMENSIONS ARE  
ESTIMATED, ACTUAL DIMENSIONS MAY  
VARY BASED UPON SITE CONDITIONS.  
GRAVEL ROAD/PAD DEPTH - 5 FT  
MIN. MATCH EXISTING OTP  
ELEVATION.

**REFERENCE:**

APPLICANT: CAELUS ENERGY  
ALASKA, LLC

PROPOSED: PAD CONSTRUCTION

AT: ALASKA

SHEET **7** of **7** 8-29-2014